

FINISH SCHEDULE

Alibaba's Kitchen Inc.

12923 S. Budlong Ave., Gardena CA 90267

Plan Check No: _____ / _____ / _____ - _____ / _____ / _____

| Room Name Floor Plan / Rooms | Floors | Base Coving | Walls | Ceiling |
|---------------------------------|------------------------|------------------------|---|---|
| 1. Storage | Smooth ceramic tile | 4" ceramic tile | Gypsum board; smooth; Matt paint, White | Drop ceiling 96" heights; vinyl faced panel; smooth; white |
| 2. Storage | Sealed smooth concrete | 6" ceramic tile | Gypsum board; smooth; Matt paint, White | Drop ceiling 96" heights; vinyl faced panel; smooth; white |
| 3. Lunchroom | Sealed smooth concrete | 6" ceramic tile | Gypsum board; smooth; White semi-gloss paint | Drop ceiling 96" heights; vinyl faced panel; smooth; white |
| 4. Mop Sink/Janitorial | Sealed smooth concrete | 6" ceramic tile | Fiberglass Reinforced Panel (FRP); white | 96" heights Gypsum board; White semi-gloss paint |
| 5. Ladies | Sealed smooth concrete | 6" ceramic tile | Gypsum board; smooth; White semi-gloss paint | 96" heights Gypsum board; White semi-gloss paint |
| 6. Men | Sealed smooth concrete | 6" ceramic tile | Gypsum board; smooth; White semi-gloss paint | 96" heights Gypsum board; White semi-gloss paint |
| 7. Electrical | Sealed smooth concrete | 6" ceramic tile | Gypsum board; smooth; White semi-gloss paint | Not Finish / Open to attic |
| 8. Cooler 1 | Sealed smooth concrete | Smooth stainless steel | Smooth stainless steel | 108" heights Smooth stainless steel |
| 9. Utensils Washing | Sealed smooth concrete | 6" ceramic tile | Fiberglass Reinforced Panel (FRP); white | 96" heights Gypsum board; White semi-gloss paint |
| 10. Packing Area | Sealed smooth concrete | 6" ceramic tile | Fiberglass Reinforced Panel (FRP); white | 108" heights Drop ceiling; vinyl faced panel; smooth; white |

FINISH SCHEDULE

Alibaba's Kitchen Inc.

12923 S. Budlong Ave., Gardena CA 90267

Plan Check No: _____ / _____ / _____ - _____ / _____ / _____

| Room Name Floor Plan / Rooms | Floors | Base Coving | Walls | Ceiling |
|---------------------------------|--|------------------------|---|---|
| 11. Cooler 2 | Sealed smooth concrete Name of sealer | Smooth stainless steel | Smooth stainless steel | 104" heights Smooth stainless steel |
| 12. Storage A | Sealed smooth concrete | 6" ceramic tile | Gypsum board; smooth; White semi-gloss paint | 96" heights Gypsum board; White semi-gloss paint |
| 13. Storage B | Sealed smooth concrete | 6" ceramic tile | Gypsum board; smooth; White semi-gloss paint | 96" heights Gypsum board; White semi-gloss paint |
| 14. Cooking | Sealed smooth concrete | 6" ceramic tile | Fiberglass Reinforced Panel (FRP); white | 144" heights Gypsum board; White semi-gloss paint |
| 15. Freezer | Smooth stainless steel | Smooth stainless steel | Smooth stainless steel | 105" heights Smooth stainless steel |
| 16. Shipping | Sealed smooth concrete | 6" ceramic tile | Fiberglass Reinforced Panel (FRP); white | 108" heights Drop ceiling; vinyl faced panel; smooth; white |
| 17. Hallways | Sealed smooth concrete | 6" ceramic tile | Fiberglass Reinforced Panel (FRP); white | 96" heights Gypsum board; White semi-gloss paint |
| 18. Filling Area | Sealed smooth concrete | 6" ceramic tile | Fiberglass Reinforced Panel (FRP); white | 96" heights Gypsum board; White semi-gloss paint |
| 19. Boxing Area | Sealed smooth concrete | 6" ceramic tile | Fiberglass Reinforced Panel (FRP); white | 108" heights Drop ceiling; vinyl faced panel; smooth; white |

FINISH SCHEDULE

Alibaba's Kitchen Inc.

12923 S. Budlong Ave., Gardena CA 90267

Plan Check No: _____ / _____ / _____ - _____ / _____ / _____

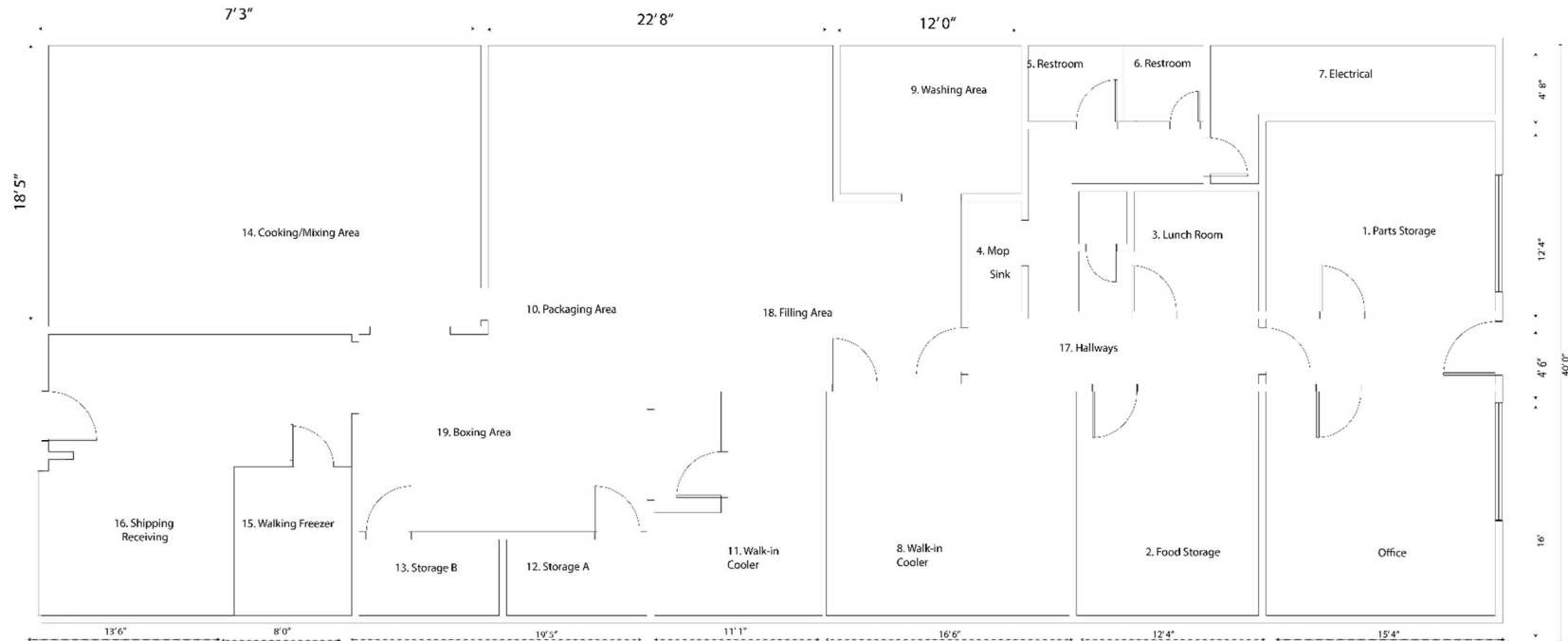

Finish Schedule

| Room Name | Floors | Base Coating | Walls | Ceiling |
|------------------------|------------------------|------------------------|--|---|
| 1. Storage | Smooth ceramic tile | 4" ceramic tile | Gypsum board, smooth; Mar. paint, White | Drop ceiling 90" heights; vinyl faced panel; smooth; white |
| 2. Storage | Sealco smooth concrete | 6" ceramic tile | Gypsum board, smooth; Mar. paint, White | Drop ceiling 90" heights; vinyl faced panel; smooth; white |
| 3. Lunchroom | Sealco smooth concrete | 6" ceramic tile | Gypsum board, smooth; White semi gloss paint | Drop ceiling 90" heights; vinyl faced panel; smooth; white |
| 4. Mop Sink/Janitorial | Sealco smooth concrete | 6" ceramic tile | Gypsum board, smooth; White semi-gloss paint | 90" heights Gypsum board; White semi-gloss paint |
| 5. Ladies | Sealco smooth concrete | 6" ceramic tile | Gypsum board, smooth; White semi-gloss paint | 90" heights Gypsum board; White semi-gloss paint |
| 6. Men | Sealco smooth concrete | 6" ceramic tile | Gypsum board, smooth; White semi-gloss paint | 90" heights Gypsum board; White semi-gloss paint |
| 7. Linenroom | Sealco smooth concrete | 6" ceramic tile | Gypsum board, smooth; White semi-gloss paint | 90" heights Gypsum board; White semi-gloss paint |
| 8. Cooler 1 | Sealco smooth concrete | Smooth stainless steel | Smooth stainless steel | 105" heights Smooth stainless steel |
| 9. Linens Washing | Sealco smooth concrete | 6" ceramic tile | Fiberglass Reinforced Panel (FRP); white | 90" heights Gypsum board; White semi-gloss paint |
| 10. Packing Area | Sealco smooth concrete | 6" ceramic tile | Fiberglass Reinforced Panel (FRP); white | 105" heights Drop ceiling; vinyl faced panel; smooth; white |
| 11. Cooler 2 | Sealco smooth concrete | Smooth stainless steel | Smooth stainless steel | 104" heights Smooth stainless steel |
| 12. Storage A | Sealco smooth concrete | 6" ceramic tile | Gypsum board, smooth; White semi gloss paint | 90" heights Gypsum board; White semi gloss paint |
| 13. Storage B | Sealco smooth concrete | 6" ceramic tile | Gypsum board, smooth; White semi-gloss paint | 90" heights Gypsum board; White semi-gloss paint |
| 14. Cooking | Sealco smooth concrete | 6" ceramic tile | Fiberglass Reinforced Panel (FRP); white | 144" heights Gypsum board; White semi-gloss paint |
| 15. Freezer | Smooth stainless steel | Smooth stainless steel | Smooth stainless steel | 120" heights Smooth stainless steel |
| 16. Shipping | Sealco smooth concrete | 6" ceramic tile | Fiberglass Reinforced Panel (FRP); white | 105" heights Drop ceiling; vinyl faced panel; smooth; white |
| 17. Hallways | Sealco smooth concrete | 6" ceramic tile | Fiberglass Reinforced Panel (FRP); white | 90" heights Gypsum board; White semi-gloss paint |
| 18. Filling Area | Sealco smooth concrete | 6" ceramic tile | Fiberglass Reinforced Panel (FRP); white | 90" heights Gypsum board; White semi-gloss paint |
| 19. Boxing Area | Sealco smooth concrete | 6" ceramic tile | Fiberglass Reinforced Panel (FRP); white | 105" heights Drop ceiling; vinyl faced panel; smooth; white |

Floor Plan / **Finish Schedule**
 Scale 1/4" = 1'
 Page 1

Alibaba's Kitchen Inc.
 12923 S. Budlong Ave., Gardena, CA 90247
 714-280-6488
 Ali@homafood.com

Window 
 Rollup Door 

Alibaba's Kitchen Inc.

12923 S. Budlong Ave., Gardena CA 90267

Plan Check No: _____ / _____ / _____ - _____ / _____ / _____

Equipment Schedule

| Equipment | Manufacturer | Model # | Electrical | Plumbing | Gas |
|---------------------------|---------------------|----------------|-------------------|--------------------------------|--------------------|
| 1. Stock pot stove A | | | | | 20,000 btu |
| 2. Stock pot stove B | | | | | 20,000 btu |
| 3. Stock pot stove C | | | | | 20,000 btu |
| 4. Walk in Cooler | Heat Craft Inc. | | 120v, 1Ø 15 AMP | Floor Sink 17 indirect | |
| 5. Walk in Freezer | Heat Craft Inc. | | 220v, 1Ø 15 AMP | Floor Sink 18 indirect | |
| 6. Hobart Mixer / Grinder | Hobart | | 220v, 3Ø 30 AMP | | |
| 7. Accumulating Table | | | 120v, 1Ø 1 AMP | | |
| 8. 4 Head Filler | | | 120v, 1Ø 1 AMP | Floor Sink indirect | |
| 9. Capping Machine | | | 120v, 1Ø 1 AMP | | |
| 10. Labeling Machine | | | 120v, 1Ø 1 AMP | | |
| 11. Collection Table | | | 120v, 1Ø 1 AMP | | |
| 12. Bottle Filling | | | 120v, 1Ø 1 AMP | | |
| 13. Pallet Wrapper | | | 220v, 1Ø 3 AMP | | |
| 14. 3 Compartment Sink 9 | | | | Hot, Cold, Direct | |
| 15. Food prep. Sink 10 | | | | Hot, Cold, Floor Sink indirect | |
| 16. Hand Wash Sink 9 | | | | Hot, Cold, Direct | |
| 17. Hand Wash Sink 18 | | | | Hot, Cold, Direct | |
| 18. Hand Wash Sink 14 | | | | Hot, Cold, Direct | |
| 19. Water Heater | A.O. Smith | URG275H6N | | Hot, Cold, Outside drain | 75 gal., 76000 Btu |
| 20. Circulation Pump | Grundfos | UP15-29SF | 115v, 1Ø .75 AMP | Hot water Circulation | |
| 21. Air Curtain A | | | 120v, 1Ø 2 AMP | | |
| 22. Air Curtain B | | | 120v, 1Ø 3 AMP | | |

Alibaba's Kitchen Inc.

12923 S. Budlong Ave., Gardena CA 90267

Plan Check No: _____ / _____ / _____ - _____ / _____ / _____

| Equipment | Manufacturer | Model # | Electrical | Plumbing | Gas |
|------------------------------|-------------------|---------|-----------------|---------------------------------|-----|
| 23. Plastic Curtain Strips | | | | | |
| 24. 8 Metro Shelves 6'x6'x2' | | | | | |
| 25. Vacuum Sealer | | Z520 | 220v, 1Ø 5 AMP | | |
| 26. Mop Sink wall Mounted 10 | | | | Hot, Cold, Indirect, Floor Sink | |
| 27. Wall Mounted Faucet | PROFLO | PF1119 | | Hot, Cold | |
| 28. Soap & Towel Dispensers | | | | | |
| 29. Shrink Tunnel | Shanklin | T-71XL | 220v, 3Ø 30 AMP | | |
| 30. Exhaust Ventilation | Rivera Metal Pro. | | 120v, 1Ø | | |
| 31. Climate Control A | Heat Craft Inc. | CWA270 | 120v, 1Ø | Floor Sink indirect | |
| 32. Climate Control B | Heat Craft Inc. | CWA270 | 120v, 1Ø | Floor Sink indirect | |
| 33. Table 72'x30' | | | | | |
| 34. Table 96'x62' | | | | | |
| 35. Men | | | | Cold, Direct | |
| 36. Women | | | | Cold, Direct | |
| 37. M Handwash Sink | | | | Hot, Cold, Direct | |
| 38. W Handwash Sink | | | | Hot, Cold, Direct | |
| 39. Air Pump | | | | | |
| 40. 2 Nozzles Filler | | | 120v, 1Ø | | |
| 41. Cup Sealer | | | 120v, 1Ø | | |
| 42. Bag Filler | | | 120v, 1Ø | | |
| 43. Food Slicer | | | 220v, 1Ø 3 AMP | | |
| 44. Small Labeler | | | 120v, 1Ø | | |
| 45. Veggie Chopper | | | 120v, 1Ø | | |
| 46. Veggie Cube Machine | | | 220v, 1Ø 3 AMP | | |

Alibaba's Kitchen Inc.

12923 S. Budlong Ave., Gardena CA 90267

Plan Check No: _____ / _____ / _____ - _____ / _____ / _____

| Equipment | Manufacturer | Model # | Electrical | Plumbing | Gas |
|-------------------------|--------------|---------|-----------------|----------|-----|
| 47. Small Shrink Tunnel | | | 220v, 3Ø 30 AMP | | |
| 48. Vertical Bag Sealer | | | 120v, 1Ø | | |
| 49. Tub Sealer | | | 120v, 1Ø | | |
| 50. Scale | | | | | |
| 51. Grinder B | | | 120v, 1Ø | | |
| 52. Table 48" x 30" | | | | | |
| 53. Sheet Pan Rack X 5 | | | | | |
| 54. | | | | | |
| 55. | | | | | |
| 56. | | | | | |